

IBZA 6+: Ultra-Compact Full Range Loudspeaker

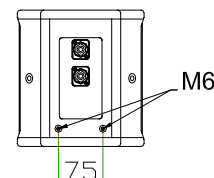
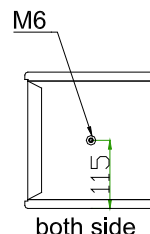
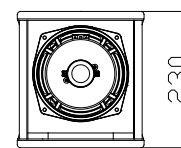
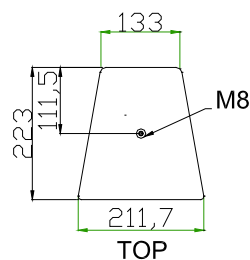

MAIN APPLICATIONS

- Background Music in restaurants, club, airports
- Museums and AV spaces
- Convention centres
- Hotels
- Distributed, Fill and Bajo Balcony

MAIN FEATURES

- Compact two-way passive system
- 6 1/2" Coaxial loudspeaker
- 8 Ω nominal impedance
- Mounting accessories

DESCRIPTION

The **IBIZA6+** is a very small compact full range loudspeaker of studio sound quality, designed to be used in wide variety of audio applications where a small size although very high output SPL is required.

With a Coaxial technology, the enclosure design allows for installation very close to walls and ceilings making it an ideal choice for short throw applications like distributed, under balcony or wall mounting.

The IBZA6+ is a two-way passive system with a 6 1/2" low-mid frequency driver in a bass-reflex tuned enclosure and a 1" compression driver attached to horn in coaxially-mounted. The combination provide a natural and transparent sound.

The IBZA6Plus operate over a frequency range of 85Hz to 18 kHz. Suitable for use as stand-alone speaker or extended frequency response down with a passive sub-woofer like SW12 or SW115.

The box houses multiple internal rigging points M6 and M8 insert for different flying bracket.

The cabinet is coated with rugged Polyurea texture finish and protected with special grills.

Frequency Response ¹	85 Hz - 20 kHz
Frequency Response: Free Field ²	100 Hz - 18 kHz ±3 dB
Axial Sensitivity @ 1W/1m	93 dB
Calculate SPL	116dB / 122 dB peak
Transducers: Low/High Frequency	1 x 6 1/2" cone drivers and 1 x 1" compression drive, coaxially-attached
Dispersions (HxV)	70° x 70°
Recommended amplifier	PA900/PA4.450/T6-44
Power (AES) ³	160 W
Power (Continuous)	320 W
Rate Impedance	8 Ω
Input Connectors	IN: 1 x NL4 SpeakON® LINK: 1 x NL4 SpeakON®
NET Weight	5,3 kg (11,68 lbs)
Dimensions (HxWxD)	230 x 211,7 x 223 mm (HxWxD) / (9.05" x 8.31" x 8.78")
Construction	16mm birch plywood. Finished in black semi-matt textured Polyurea weatherized coating
Protective Grille	Powder coated perforated steel with acoustically transparent reticulated fabric

¹ Recommended maximum operating frequency range. Response depends on loading conditions and room acoustics.

² Free field measured with 1/3 octave frequency resolution at 4m

³ Based on AES Standard, 2 hours test applying 6dB crest factor pink noise signal withing the range Fs-10Fs (AES-1984)



Pº Ind. Monte Boyal, C/Encinar 282
45950 Casarrubios del Monte (Toledo), SPAIN.
Phone: +34 918 170 110
Fax: +34 918 183 053
www.tecnare.com
sales@tecnare.com